

EASY SPRING WAND INSTALLATION MANUAL

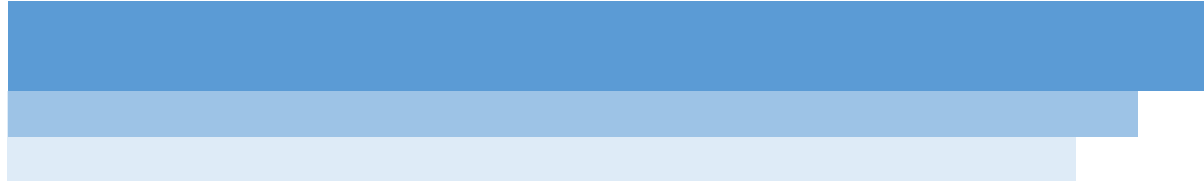

April 2018



www.shadesbymatiss.com | T. 800 493 2040 | email: info@shadesbymatiss.com

**ROLLEASE
ACMEDA**
PRECISION IN MOTION

CONTENTS

April 2018

This manual is to be read in conjunction with the Product Specifications & Assembly manual

SECTION NO.	DESCRIPTION	PAGE NO.
SECTION 1 – ITEMS REQUIRED		1.1
SECTION 2 – INSTALLATION		2.1
	PART A – PREPARING INSTALLATION SPACE	2.1
	PART B – MOUNTING BRACKET AND SHADE INSTALLATION	2.1
	PART C – PRETENSION CHECKS	2.3
	PART D – SET LIMITS	2.6
SECTION 3 – TROUBLESHOOTING		3.1

DISCLAIMER

INTRODUCTION

This Installation manual has been produced by Rollease Acmeda to supply the necessary information for safe and correct installation of this system.

INSTALLERS RESPONSIBILITY

Before installing, please read & ensure you understand the safety information and installation instructions as defined in this installation manual.

- If you do not fully understand these instructions, contact Rollease Acmeda for clarification before installing.
- The Installer is responsible to ensure that all installation personnel have been adequately trained on the safe & correct installation and operation.
- The Installer is responsible to ensure that a Job Safety Analysis or Safe Work Method Statement is completed prior to installation to identify hazards, to determine appropriate risk control measures and to implement the control measures.
- The Installer is responsible to ensure that supporting structures are sound and can adequately support the load.
- The Installer is responsible to ensure that the devices used to anchor the product to the supporting structure are suitable for the application.
- The fasteners provided are intended for fastener to timber. The installer is responsible for selecting fasteners that are suitable for other substrates

SAFETY INFORMATION

- Ensure Job Safety Analysis/Safe Work Method Statement is completed and actions to reduce risks are implemented.
- Ensure that electrical works are done only by a LICENSED ELECTRICIAN.
- DO NOT modify any of the components of this system.

PERSONNEL REQUIREMENTS

Only suitably trained/qualified personnel should undertake installation.

DISCLAIMER

Rollease Acmeda has used reasonable care in preparing the information included in this document, but makes no representations or warranties as to the completeness or accuracy of the information. Information is supplied upon the condition that the persons receiving the information will make their own determination as to its suitability for their purposes prior to use. Rollease Acmeda assumes no liability whatsoever for any damages incurred by you resulting from errors in or omissions from the information included herein. Rollease Acmeda reserves the right to make changes without further notice to any products to improve reliability, function or design.

COPYRIGHT

COPYRIGHT © ROLLEASE ACMEDA 2018

All rights reserved. No part of this document may be reproduced or utilized in any means, by any means, electronic or mechanical including photocopying, recordings, or by any information storage or retrieval system, without the express permission from Rollease Acmeda.



SECTION 1 – ITEMS REQUIRED

TOOLS REQUIRED

- Drill
- Drill Bits
- Measuring Tape
- Pencil
- Screw Driver - Flat Head
- 5mm Socket
- Ratchet

SHADE ITEMS REQUIRED

Check you have all items required to complete installation;

1. Shade Assembly
2. 2 x Bracket Covers
3. 2 Mounting Brackets
4. Appropriate Fasteners

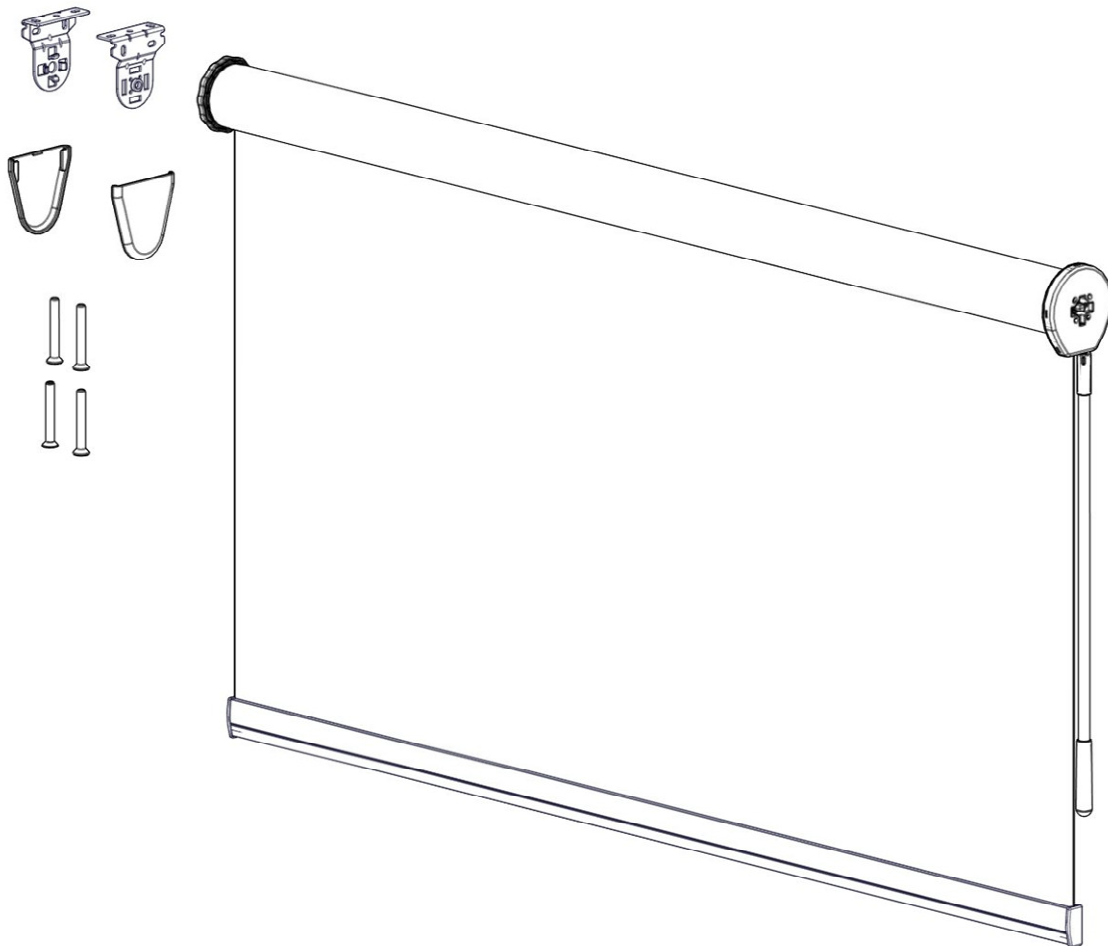

SECTION 2 – INSTALLATION

PART A – PREPARING INSTALLATION SPACE

STEP 1 – ENSURE TOP OF INSTALLATION SPACE IS LEVEL

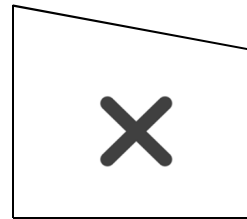

PART B – MOUNTING BRACKET AND SHADE INSTALLATION

STEP 1 – INSTALL BRACKETS TO WALL / CEILING USING APPROPRIATE FASTENERS TO SUIT APPLICATION

INSTALL BRACKETS AS PER INSTALLATION REQUIREMENTS

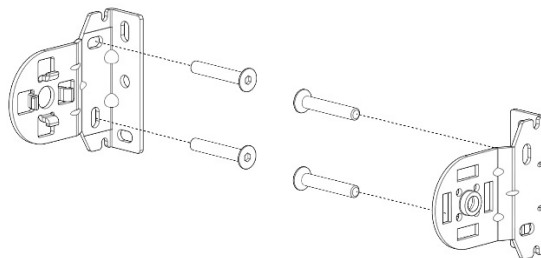
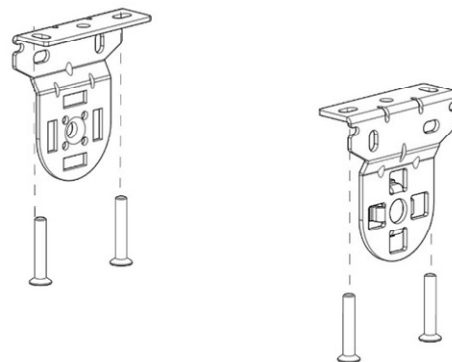
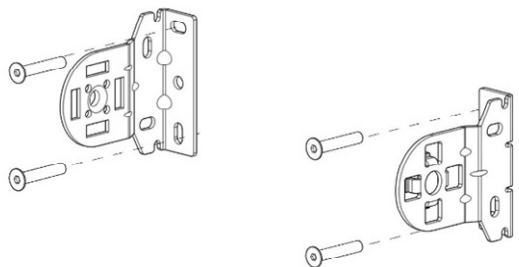

NOTE: Install additional Easy-Link bracket if required



STEP 2 – INSTALL SHADE ONTO MOUNTING BRACKETS

Note: Insert limiter end into bracket first

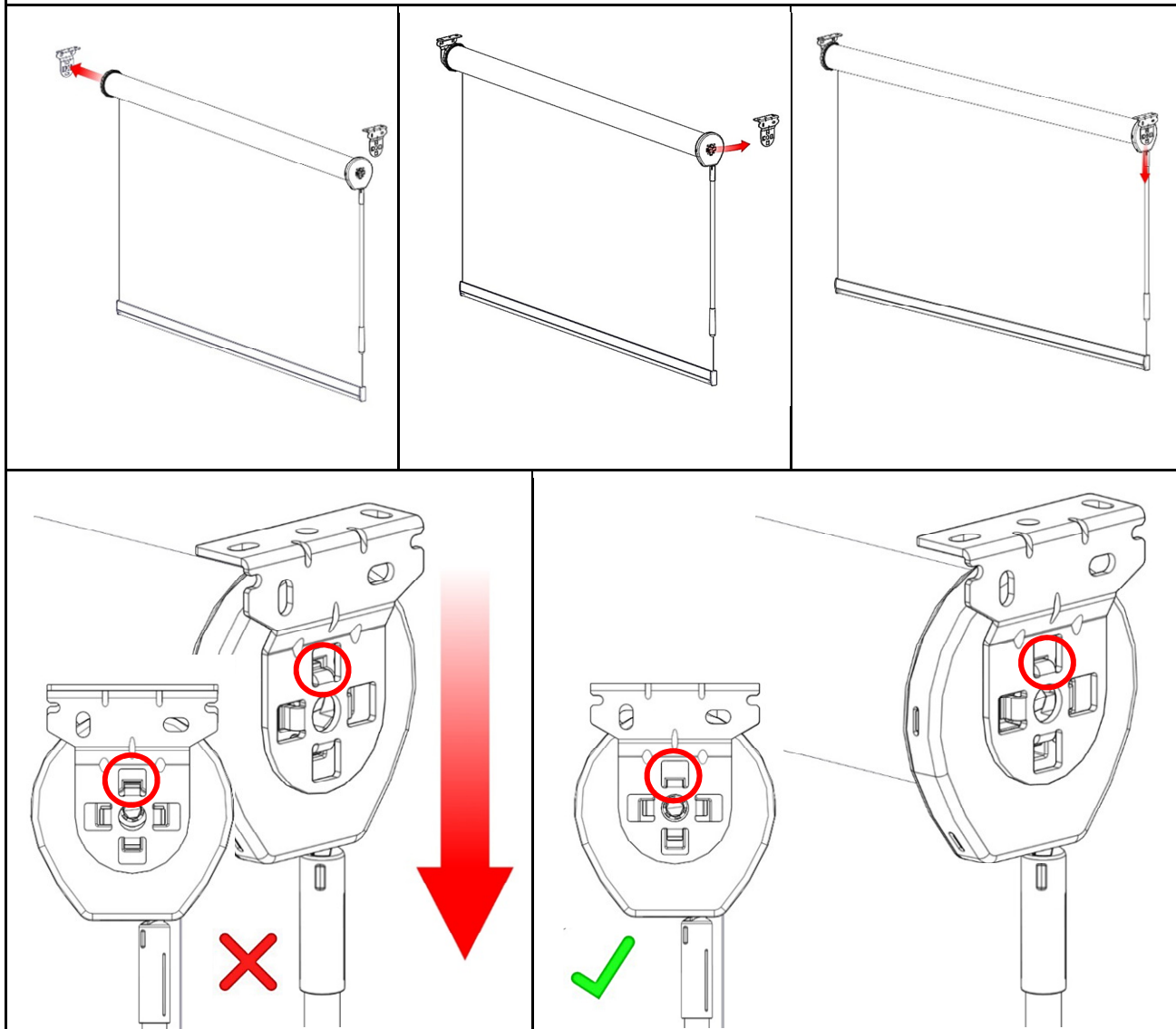

Ensure Control End is fully engaged with the top bracket tongue



STEP 1 – CHECK FUNCTIONALITY OF PRE-TENSIONED SHADE

i) **PULL** Bottom Rail down to bottom location

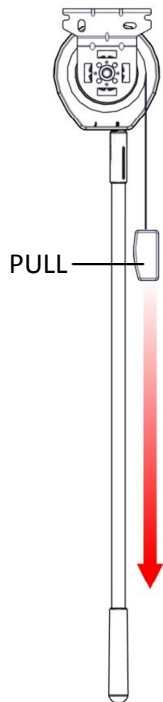

ii) Shade will raise within range indicated below to be locked and provide a 'Release Allowance' (for raising the shade)

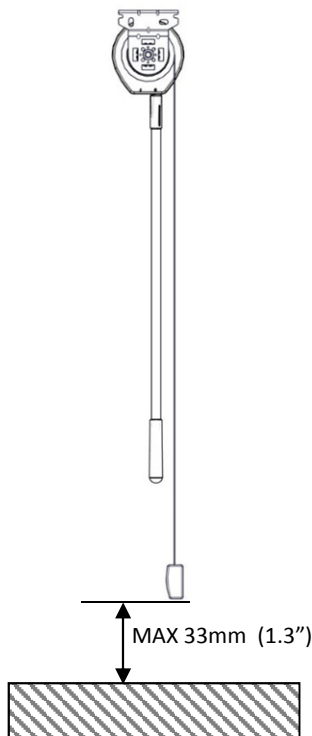

iii) **TUG** Bottom Rail (Shade will automatically rise)

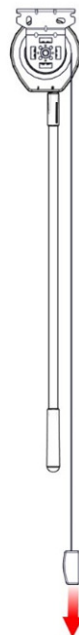

NOTE: As limits are not set, ensure Bottom Rail is controlled so Shade doesn't Crash into structure and damage fabric

If Bottom Rail raises at the desired speed, the correct number of pre-turns have been assigned

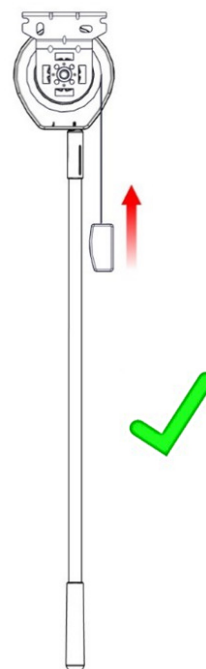

PROCEED TO PART D

If Shade stops midway or slows significantly, insufficient pre-turns have been applied.

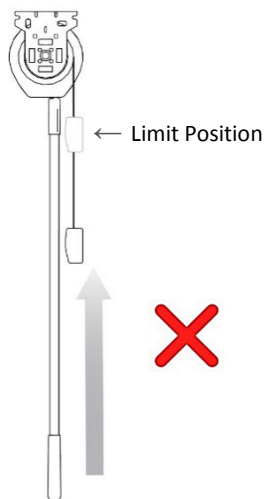

Pre-turns to be added

If Shade operates too fast, too many pre-turns have been applied.

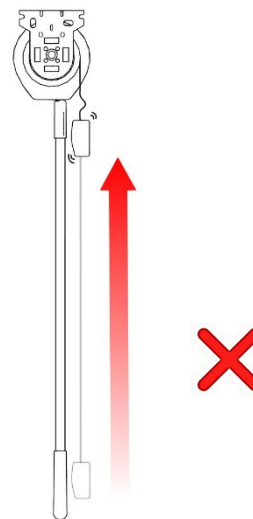

Pre-turns to be removed



BEFORE ADDING OR REMOVING PRE-TURNS

IF ADJUSTING PRETENSION WHILE SHADE IS INSTALLED:

Ensure the shade is raised fully at the top limit position before making any adjustments.

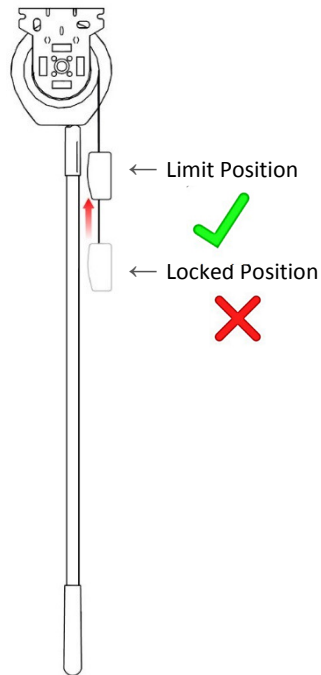

IF ADJUSTING PRETENSION WITH SHADE REMOVED FROM BRACKETS:

Before removing the shade, ensure the shade is lowered slightly in its locked position. Shade must not be resting on top limit. This is to prevent the spring from loosening the pretension when removing the shade from brackets.

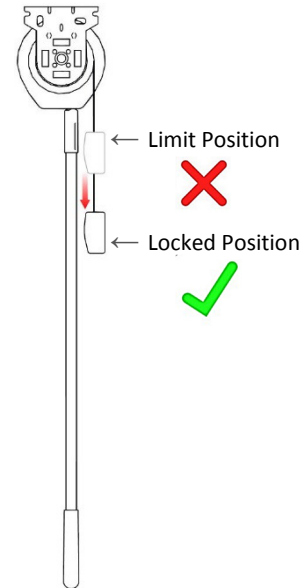

PRE-TENSION ADJUSTMENT – SHADE INSTALLED

Insert Socket Ratchet onto adjusting shaft and rotate in counter clockwise to increase pre-turns as required.

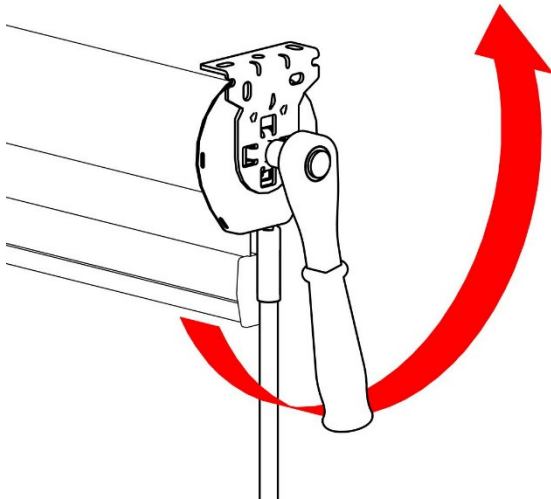

NOTE: If there is insufficient space to rotate Socket Ratchet within installation, Shade will need to be removed from the bracket to undertake process.

Re-check functionality of blind as per process i, ii & iii outlined above in this step.

(Pretension direction is reversed for LH control)

Insert Socket Ratchet onto adjusting shaft and rotate in a clockwise direction to decrease pre-turns as required.

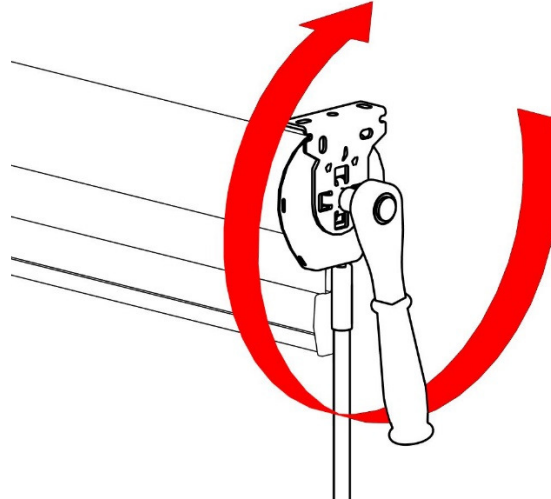

NOTE: If there is insufficient space to rotate Socket Ratchet within installation, Shade will need to be removed from the bracket to undertake process.

Re-check functionality of blind as per process i, ii & iii outlined above in this step.

(Pretension direction is reversed for LH control)

PRE-TENSION ADJUSTMENT – SHADE REMOVED

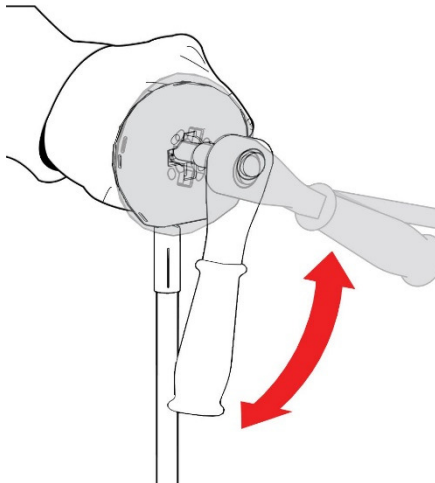

Hold the shade and use the Socket Ratchet to rotate the adjusting shaft (and wand control head) in an anti-clock wise direction enough to release the booster lock. The ratchet will move back under the spring tension.

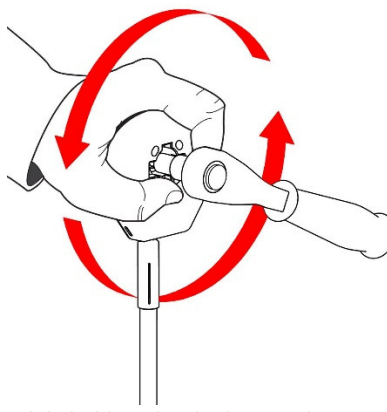

While holding the shade, grip the wand control head and also prevent both from turning. To add tension, rotate the Socket Ratchet for the number of turns desired in a counter clockwise. (Note, to remove tension allow the spring to unwind in the clockwise direction)

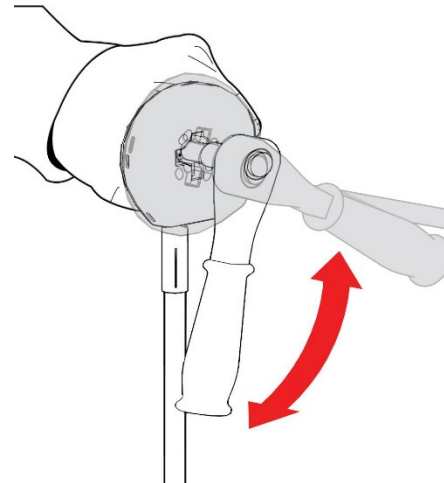

To re-lock the booster and shade, while holding the shade, release the wand control and rotate the Socket Ratchet enough to re-engage the lock (approx. ¼ turn). The ratchet should move back under the booster tension to the locked position.



PART D – SET LIMITS

STEP 1 – SET TOP LIMIT

Ensure Shade is fully raised

To lower the top limit position rotate limiter head so that the Shade moves down.

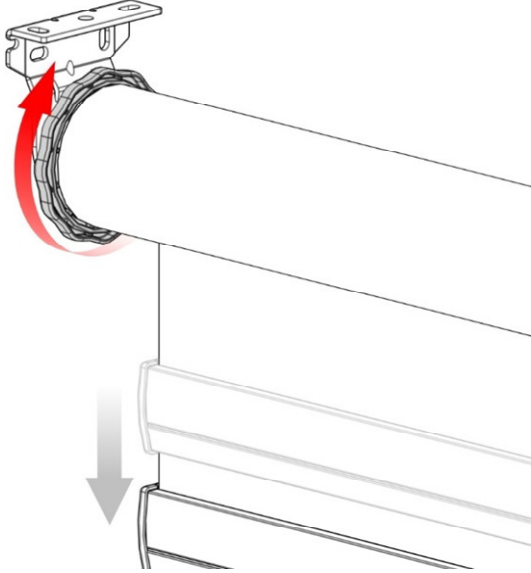

To raise the top limit position rotate limiter head so that the Shade raises.

NOTE: The shade must not be locked by the spring to allow the bottom rail to move up

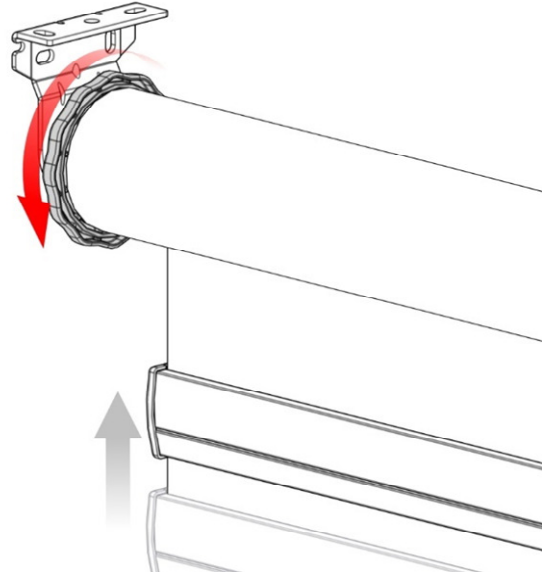

*Standard back roll shown, reverse for front roll

STEP 2 – TEST LIMITS & SHADE FUNCTIONALITY

Operate Shade up & down

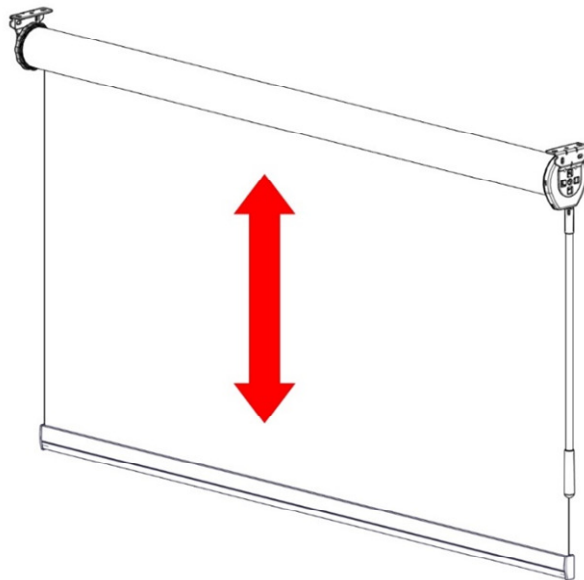

STEP 3 – SLIDE END CAP COVERS OVER BRACKETS

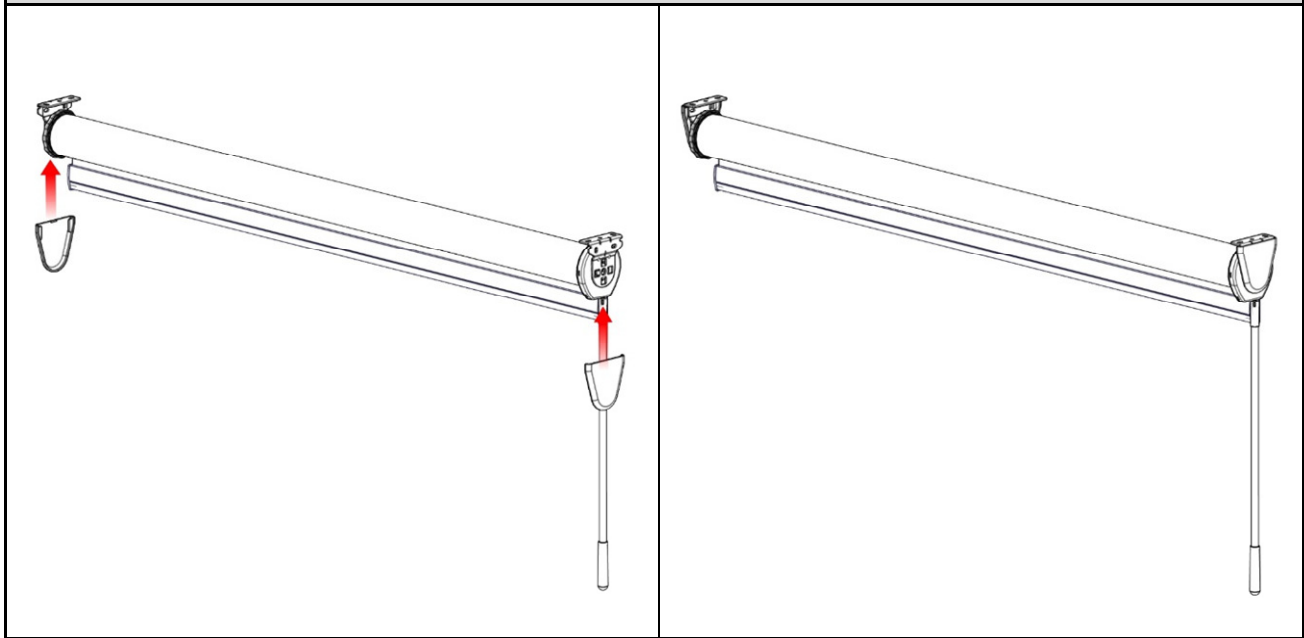

SECTION 3 – TROUBLESHOOTING

NO.	PROBLEM	CAUSE	SOLUTION
1	Cannot find limit	Limit incorrectly Set	a) Allow blind to raise fully b) If the bottom rail is too high and contacting the brackets, then... i. Wind limit adjustment wheel in the direction that would lower the Shade * ii. When the Shade starts to lower this indicates the limit has been engaged c) Use limit adjustment wheel to raise or lower limit as required * Note : If limit wheel appears to require numerous turns, raise the Shade to approximate top limit position, un-install the shade from mounting brackets, remove the limiter from the tube, rotate and move limit nut to appropriate stop position. Reassemble and re-install Shade to adjust top limit. Refer to "Section 2, Part D"
2	Erratic Behaviour Shade falls	Connector on wrong end	Remove and re-install on other end (See Assembly Manual, Section 2, Part C)
		No Pre-Turns	Add pretensions (See Section 2, Part C)
3	Shade rises too quickly	Wrong Decelerator	Remove and re-install correct Decelerator (See Assembly Manual, Section 2, Part B)
		Too many preturns	Remove pre-turns (See Section 2, Part C)
4	Operation of the wand does not lower or release shade	Incorrect hand Control	Remove control and replace with correct hand control
		Control is not fully engaged with Connector	Check deductions and/or bracket spacing are correct and according to the specifications
5	Shade does not raise	Incorrect hand Booster	Remove control and re-orientate the booster (See Assembly Manual, Section 2, Part C)
		Control is not fully engaged with Booster	Remove control and check with booster (See Assembly Manual, Section 2, Part B)
		Not enough pre-turns	Add pretensions (See Section 2, Part C)