

SKYLINE CLUTCH OPERATED ROLLER SHADE

Please check all appropriate selections and attach room schedule with verified dimensions.

Select Roller Shade System

- ☐ Single Roller (standard)
- ☐ Dual Roller (optional)

Select Clutch Location

(As seen from INSIDE the room facing the window. Also indicate on room schedule)

- ☐ Right (standard)
- ☐ Left

Select Clutch Color

- ☐ White (standard)
- ☐ Black
- ☐ Gray

Optional Spring Assist

- ☐ Spring Assist per manufacturer's standards (as required based on fabric weight)
- ☐ Spring Assist on all units (Minimum Shade width 48")
- ☐ Spring Assist as indicated on room schedule

Select Bead Chain Type

- ☐ Nickel Plated Steel Chain (standard)
- ☐ Stainless Steel
- ☐ Plastic Bead Chain
- ☐ White ☐ Vanilla ☐ Gray ☐ Brown ☐ Black

Select Cord Tension Device

- ☐ 'P'-Clip Cord Tension Device (standard)
- ☐ Chainhold Tension Device
- ☐ White ☐ Clear ☐ Gray ☐ Black

Select Fabric Orientation

- ☐ Regular Roll (standard, fabric comes from back of roller)
- ☐ Reverse Roll (optional, fabric comes from front of roller *not available with 3" or 4" fascia)

Select Bottom Rail Option

- ☐ Heat Seal (standard, sealed pocket closed on all sides)
- ☐ Rounded external hembar
- ☐ White ☐ Vanilla ☐ Gray ☐ Black
- ☐ Architectural hembar color finishes: white, gray
- ☐ White ☐ Gray
- ☐ Premium D30 bottom rail
- ☐ White ☐ Gray ☐ Black

Single Roller Shade Options

Fabric Series: _____

Color Name / Number: _____

Openness Factor: _____

Dual Roller Shade Back Shade Options

Fabric Series: _____

Color Name / Number: _____

Openness Factor: _____

Select Top Treatment

- ☐ Open Roll (standard for Dual or Single Shade)
- | | | |
|--|--|---|
| <input type="radio"/> 3" Fascia
(Single Shade Only) | <input type="radio"/> 4" Fascia
(Single Shade Only) | <input type="radio"/> 5" Fascia
(Single Shade or Dual) |
| <input type="radio"/> White | <input type="radio"/> White | <input type="radio"/> White |
| <input type="radio"/> Black | <input type="radio"/> Black | <input type="radio"/> Black |
| <input type="radio"/> Anodized | <input type="radio"/> Anodized | <input type="radio"/> Anodized |
| <input type="radio"/> Bronze | <input type="radio"/> Bronze | |
| <input type="radio"/> Vanilla | <input type="radio"/> Vanilla | |
- | | | | |
|---------------------------------|---------------------------------|---------------------------------|---------------------------------|
| <input type="radio"/> 3" Pocket | <input type="radio"/> 4" Pocket | <input type="radio"/> 5" Pocket | <input type="radio"/> 6" Pocket |
| <input type="radio"/> White | <input type="radio"/> White | <input type="radio"/> White | <input type="radio"/> White |
| <input type="radio"/> Anodized | <input type="radio"/> Anodized | <input type="radio"/> Anodized | <input type="radio"/> Anodized |

Select Wall Clip (for Pocket)

- ☐ L - Clip
- ☐ I - Clip

Select Closure Panel for Pocket or Wall Clip (white only)

- ☐ 2"
- ☐ 3"
- ☐ 5"

Add Edge Side Channel (blockout system)

- ☐ No ☐ Yes
- ☐ White ☐ Gray ☐ Black

SAFETY TAG

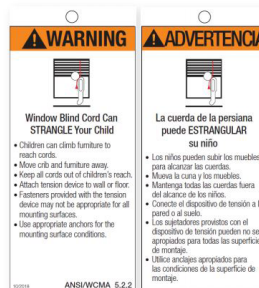

The warning tag shall be used on all window covering products that have Tension Devices (attached to Cord or Tension Device).

Item#: HD91-0120-000003

Item Description: Tension device tag 5.2.2 [2018]

Actual Label Size: 2.75" x 6.25" (large hole on top)

Addresses Section 5.2.2 ANSI/WCMA standards

Languages: English and Spanish (two sided)



SHADES BY MATISS

PROJECT:

ARCHITECT:

CONTRACTOR:

SUPPLIER:

DATE:

REVISED:

Roller Shade Accessories

Hem Bar, Chain and Clutch Options

Hembars

- Shade is supplied with a sealed pocket closed on all sides (compatible with Edge Side Channel blackout system)
- Rounded external hembar is available in white, vanilla, black and anodized color finishes (not compatible with Edge side channel blackout system)
- Fabric wrapped bottom rail is available when requested (not compatible with Edge side channel blackout system)
- Premium D30 bottom rail color finishes: white, gray, black (compatible with Edge side channel blackout system and guide wire system)
- Architectural hembar color finishes: white, gray (not compatible with Edge side channel blackout system)
- F56 color finishes: black, white (not compatible with Edge side channel blackout system)

D30 Bottom Rail

Available with fabric feeding funnel for fast and safe assembly the D30 bottom rail is also compatible with Rollease Acmeda's internal wire guide system for controlled movement of shade during operation.

D30 Features

- Slim and subtle design
- Available in Rollease Acmeda's standard roller shade color range
- Feeding Funnel set available for easy fabric assembly
- 15 mm spline compatibility
- Easy push fitment of plain end caps onto bottom rail
- Styled wire guide end caps with secure fitment to bottom rail using screws
- Compatible with Oval Ballast and with T-slot brush

Clutches

We use the following clutches:

SL-5, SL-10, SL-15, SL-20, SL-30 (clutch color finishes: white, vanilla, gray, black)
 Galaxy Geared Clutch and Galaxy Pin End Spring Assist
 Galaxy - These are gear reduction clutches that will reduce the pull forces required to operate larger shades. Galaxy Clutches are available:
 G-200, for 1 1/2" & 2" tube
 G-400, for 1 1/2", 2", 2 1/2" & 3" tube

Skyline Spring Assist Pin End and Clutch Spring Assist

When shades get larger even with stronger clutches the pull forces required get greater. We offer pin end spring assist system and clutch spring assist. When a shade is lowered, gravity is used to coil a spring attached to the pin end side of the shade. When the shade is raised the coiled spring assists the operator by reducing the pull force required up to 40%. The pin end spring assists are available with 1 1/2" and 2" tubes. The clutch side spring assists come in 2 sizes and will also add to the minimum width of the shades. These additions to the minimum width of the shades are usually not an issue as they are used on larger shades anyway.

Chains Finish

Metal Nickel over Steel bead chain

Plastic Chain Color available options: White, Vanilla, Gray, Brown, Black

System Options

Edge Side Channels for light blocking (available in white, gray, black colors, compatible with sealed hembar and D30 hembar only)

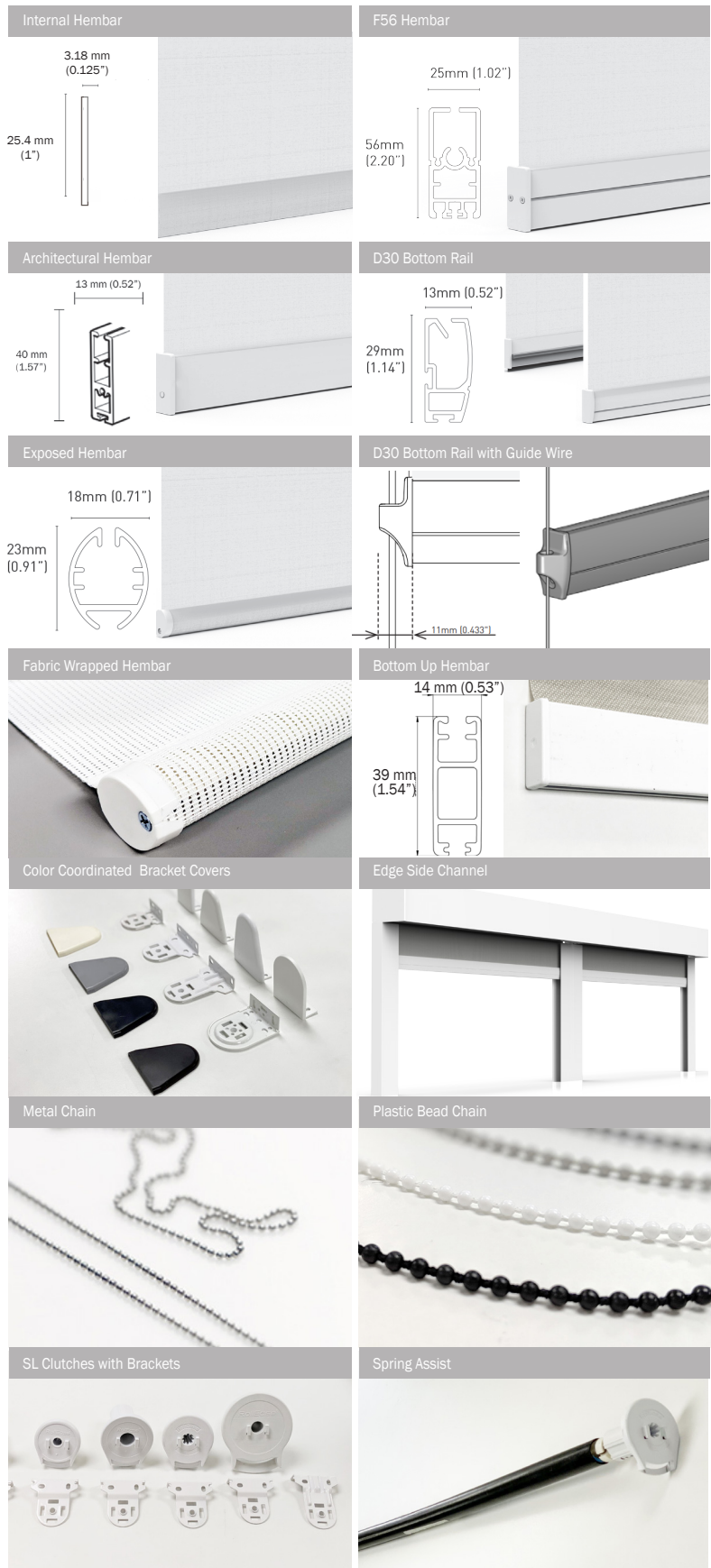

SHADES BY MATISS

Egde Channels/Guide Wire

Rollease Acmeda's EDGE SIDE CHANNELS compliment a range of cassette and fascia styles and control options with improved performance functionality and aesthetics. Designed to suit fully enclosed or partial fascia, it is compatible with the most commonly used medium roller systems. Using the EDGE SIDE CHANNELS improves the energy efficiency of any compatible system.

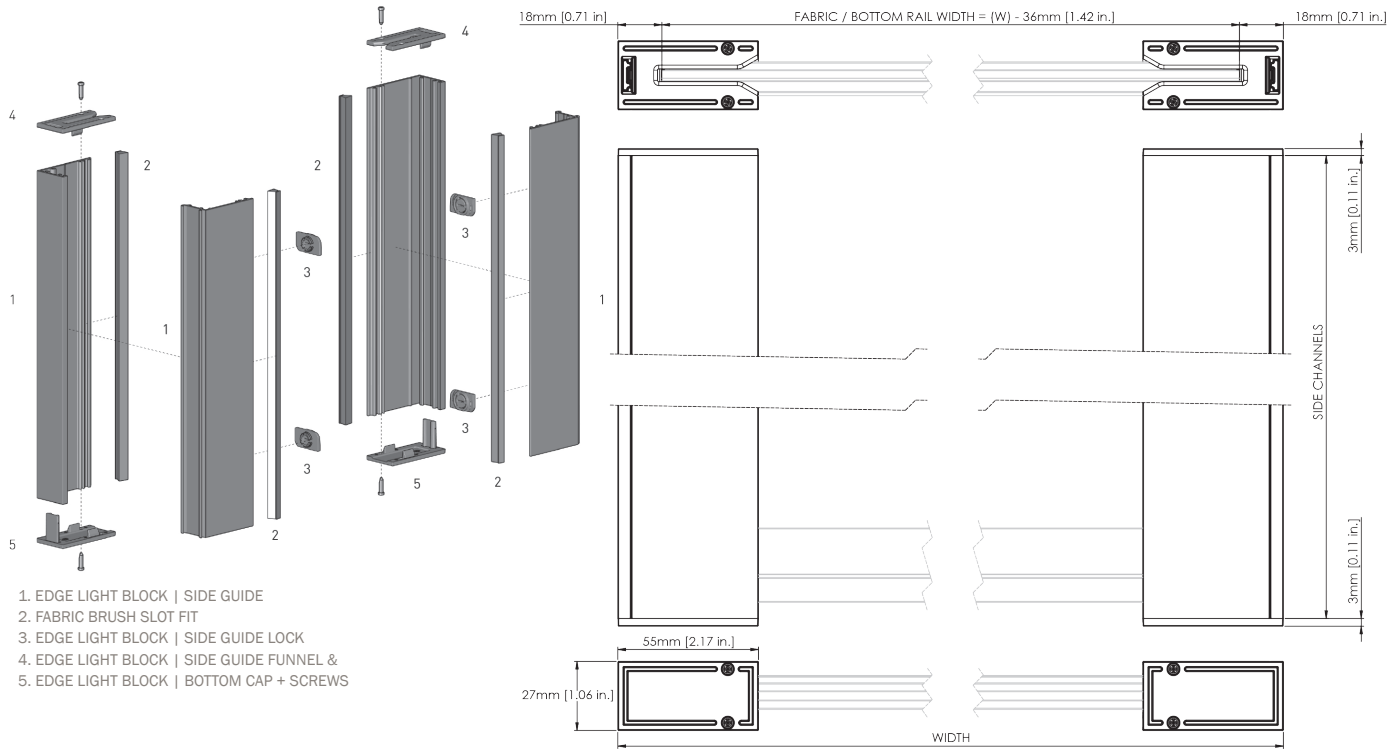

Chainhold Safety Tension Device Features and Benefits:

The Chainhold Tension Device by Rollease Acmeda provides a child safe tension mechanism for a chain roller system. Unless properly installed, the Chainhold Tension Device will partially prevent the window covering from functioning, making it fully compliant with the ANSI/WCMA standard for safety. The durable construction and engineered design of the Chainhold Tension Device ensures smooth, reliable performance.

Be the source for high quality, child safe products that are built to last.
Make child safety your priority.

- **FAST ASSEMBLY** easily and quickly assembled.
- **EASY INSTALLATION** with outside mounting bracket available
- **SLEEK APPEARANCE** small, attractive design blends with any decor
- **QUIET** reliable and efficient performance.
- **SMOOTH OPERATION** with both Rollease Acmeda metal and plastic stop balls and chain connectors.
- **AVAILABLE IN 4 FASHION COLORS** white, gray, black and a clear outside mounting bracket

OPTIONAL Chainhold Tension Device

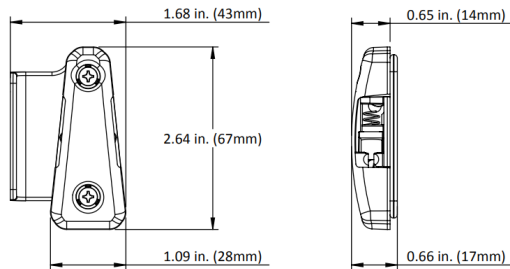

Chainhold Tension color options

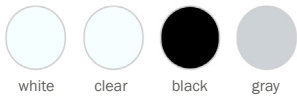

STANDARD P-CLIP Safety Tensioner

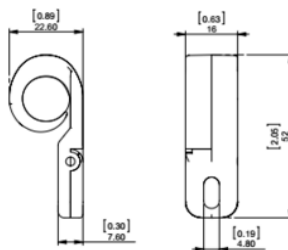

ZMC P-Clip

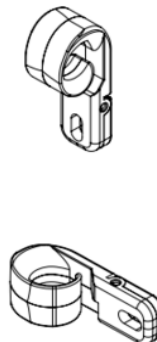

Skyline Single Manual Roller Shade

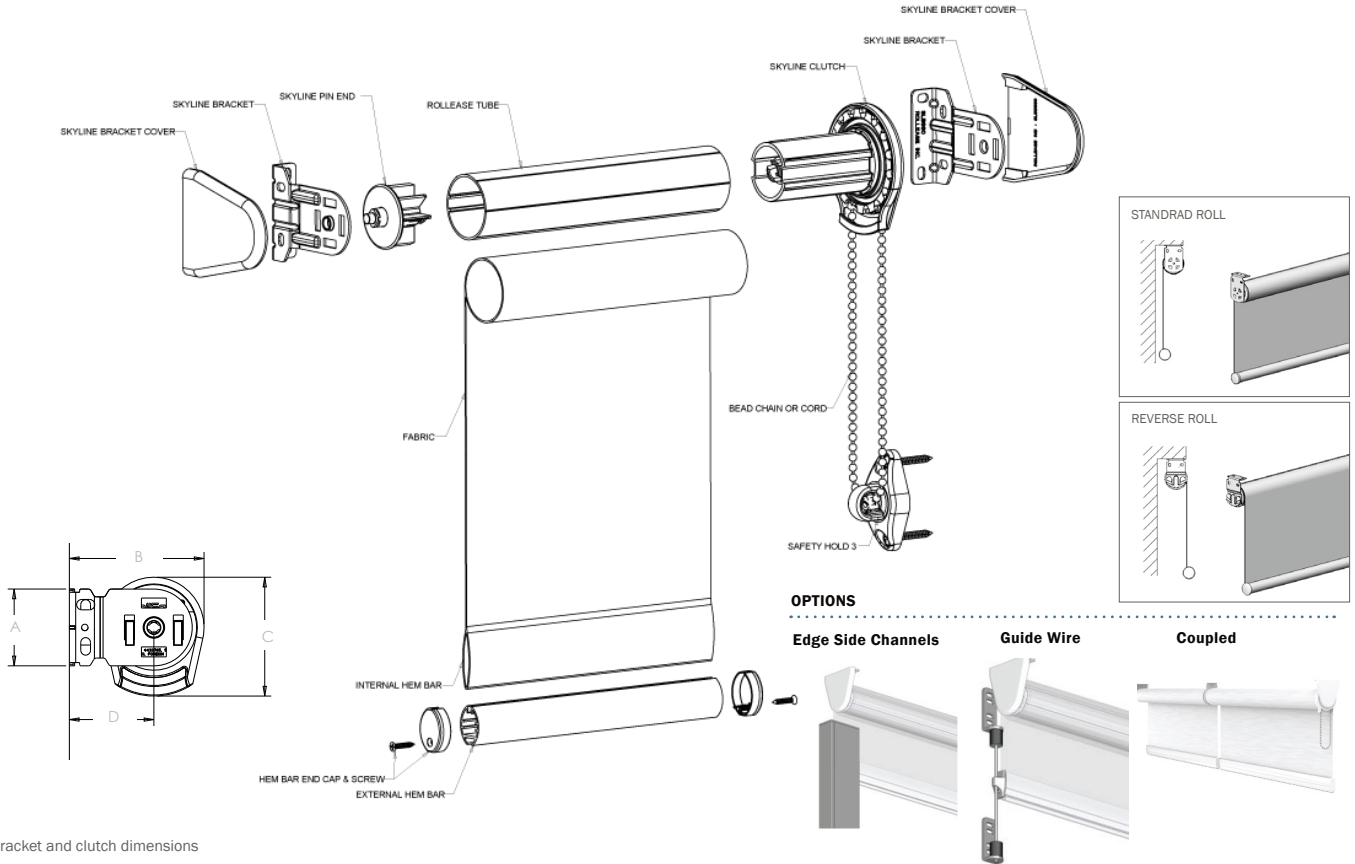

Skyline bracket and clutch dimensions

	A	B w/ SL5 clutch	B w/ SL10 clutch	B w/ SL15 clutch	B w/ SL20 or Galaxy 200 clutch	B w/ SL30 or Galaxy 400 clutch	C w/ SL5 clutch	C w/ SL10 clutch	C w/ SL15 clutch	C w/ SL20 or Galaxy 200 clutch	C w/ SL30 or Galaxy 400 clutch	D
Standard Bracket	2 1/4"	2 1/2"	2 5/8"	2 7/8"	3"	X	1 7/8"	2 3/8"	2 5/8"	3 1/8"	X	1 5/8"
Narrow Slim Bracket	1 1/2"	2"	2 3/8"	2 1/2"	X	X	1 7/8"	2 3/8"	2 5/8"	X	X	1 1/4"
Extended Bracket	2 1/4"	3"	3 1/4"	3 3/8"	3 1/2"	4"	1 7/8"	2 3/8"	2 5/8"	3 1/8"	4 3/8"	2 1/4"

x means not compatible

clutch color finishes: white, vanilla, gray, black
external hembar, end cap color finishes:
white, vanilla, gray, brown, black
Architectural and F56 white and gray only
D30 and Edge side channel color: white, gray, black

Hardware Colors



Clutch Operated Roller Shade Fabric Deductions Chart

Clutch	Inside Mount	Outside Mount	Recommended Tube Size
SL5	-1.125"	-1"	1.125"
SL10	-1.125"	-1"	1.125", 1.5"
SL15	-1.125"	-1"	1.5"
SL20	-1.25"	-1.125"	1.5", 2"
GALAXY200	-1.25"	-1.125"	2"
SL30	-1.375"	-1.25"	2.5", 3.25"
GALAXY400	-1.375"	-1.25"	2.5", 3.25"

Dual shade brackets have the same deductions as standard brackets, apart from 5" fascia dual shade brackets that require an additional 1/4" deduction. Dual shade brackets are compatible with SL-5, SL-10, SL-15, SL-20, Galaxy200 clutches.

External Hembar Upgrades (Heat Sealed comes standard)

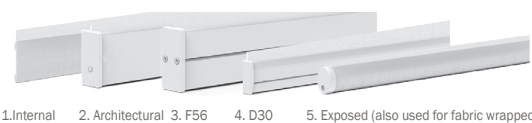

SHADES BY MATISS

Skyline Dual Manual Roller Shade

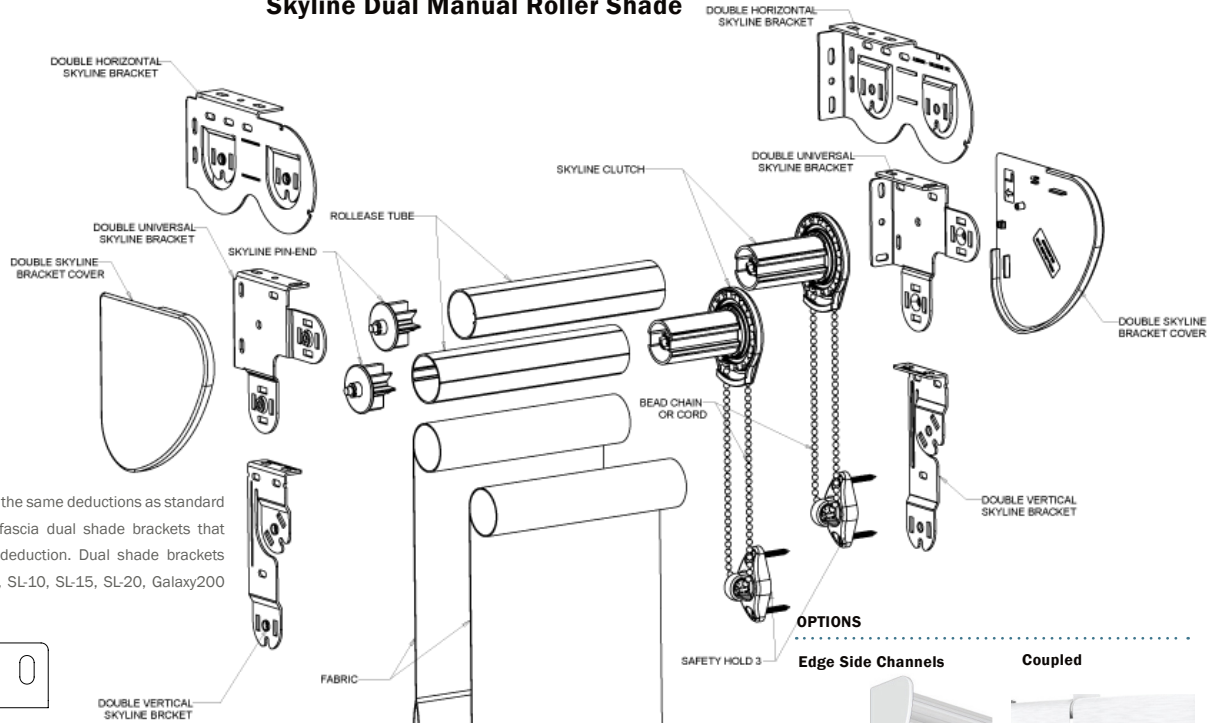

Dual shade brackets have the same deductions as standard brackets, apart from 5" fascia dual shade brackets that require an additional 1/4" deduction. Dual shade brackets are compatible with S-L5, SL-10, SL-15, SL-20, Galaxy200 clutches

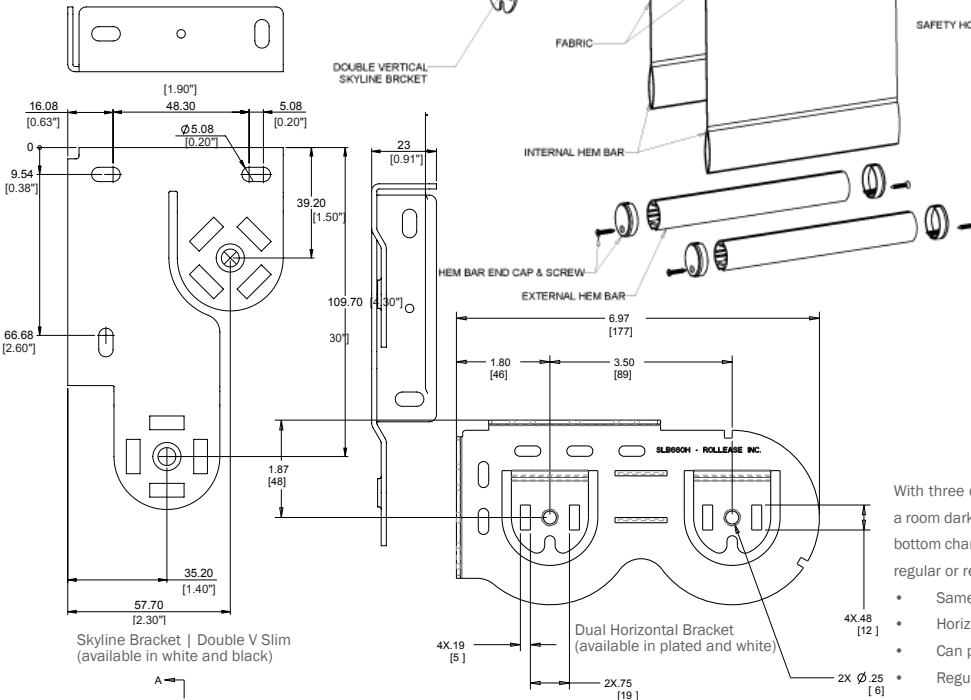

OPTIONS

Edge Side Channels

Coupled



clutch color finishes: white, vanilla, gray, black
external hembar, end cap color finishes:
white, vanilla, gray, brown, black
Architectural and F56 white and gray only
D30 and Edge side channel color: white, gray, black

Hardware Colors

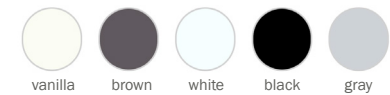

With three dual bracket options – horizontal, vertical and universal – installing a room darkening shading system is accomplished with minimal effort. Side and bottom channels available to accomplish a complete blackout system with either regular or reverse roll.

- Same benefits as single exposed roll
- Horizontal, vertical and universal bracket options
- Can provide for complete blackout installation
- Regular roll or reverse roll

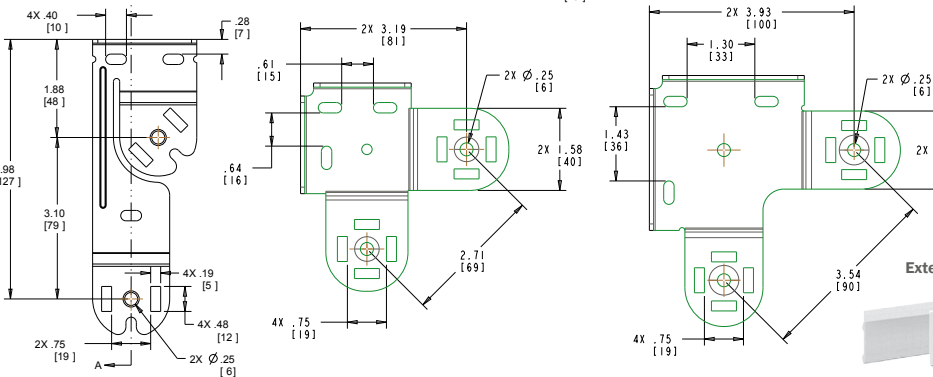

Dual Vertical Bracket
(available in plated and white)

Dual Universal Bracket 38
(available in white and black)

Dual Universal Bracket 48
(available in white and black)

External Hembar Upgrades (Heat Sealed comes standard)



1. Internal 2. Architectural 3. F56 4. D30 5. Exposed (also used for fabric wrapped)



SHADES BY MATISS

Skyline Manual Single Roller Shade with 3", 4", 5" Fascia (Optional Blackout Edge Side Channels and D30 Hembar)

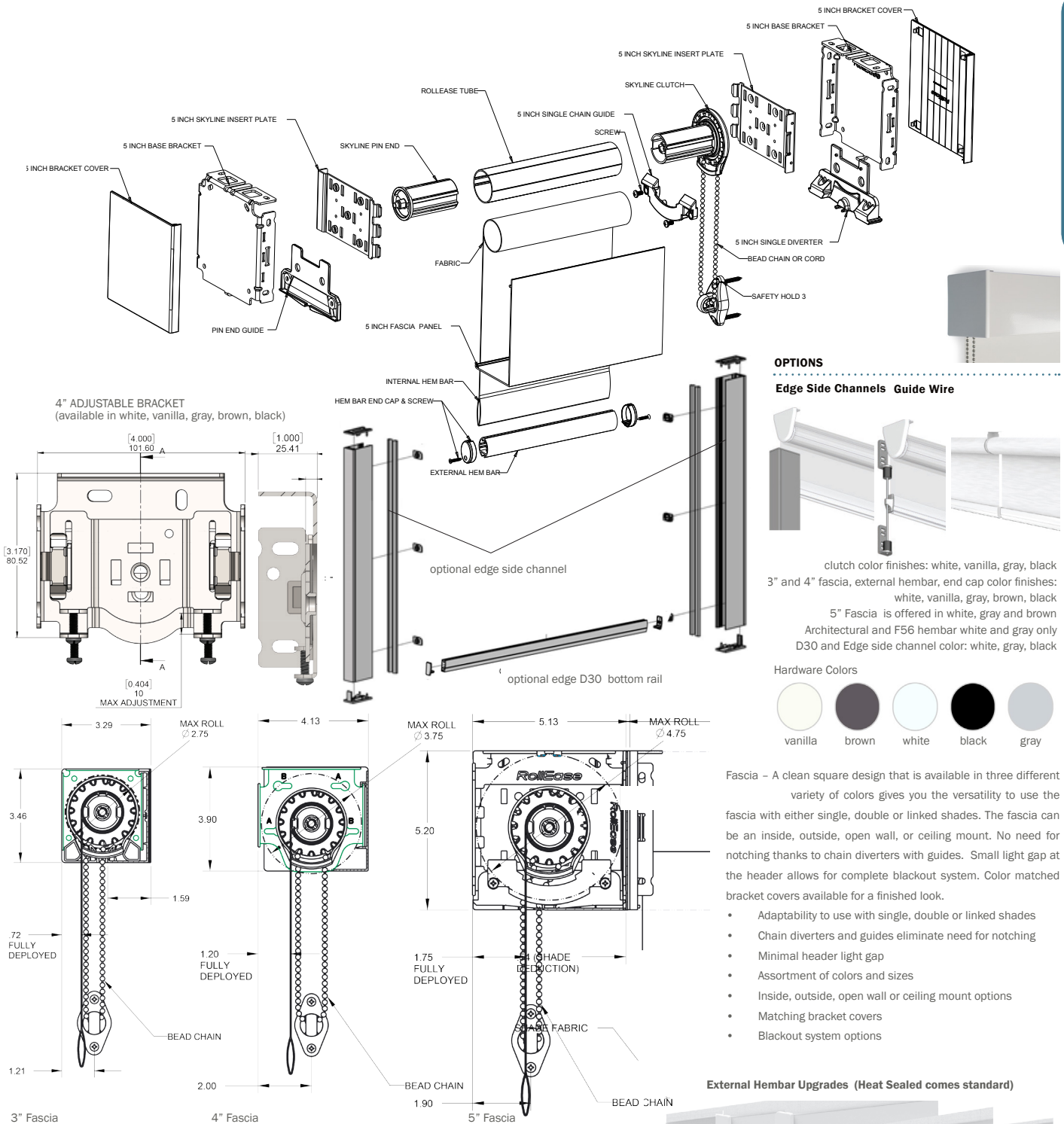

SHADES BY MATISS

Skyline Manual Dual Roller Shade with 5" Fascia (Optional Blackout Edge Side Channels and D30 Hembar)

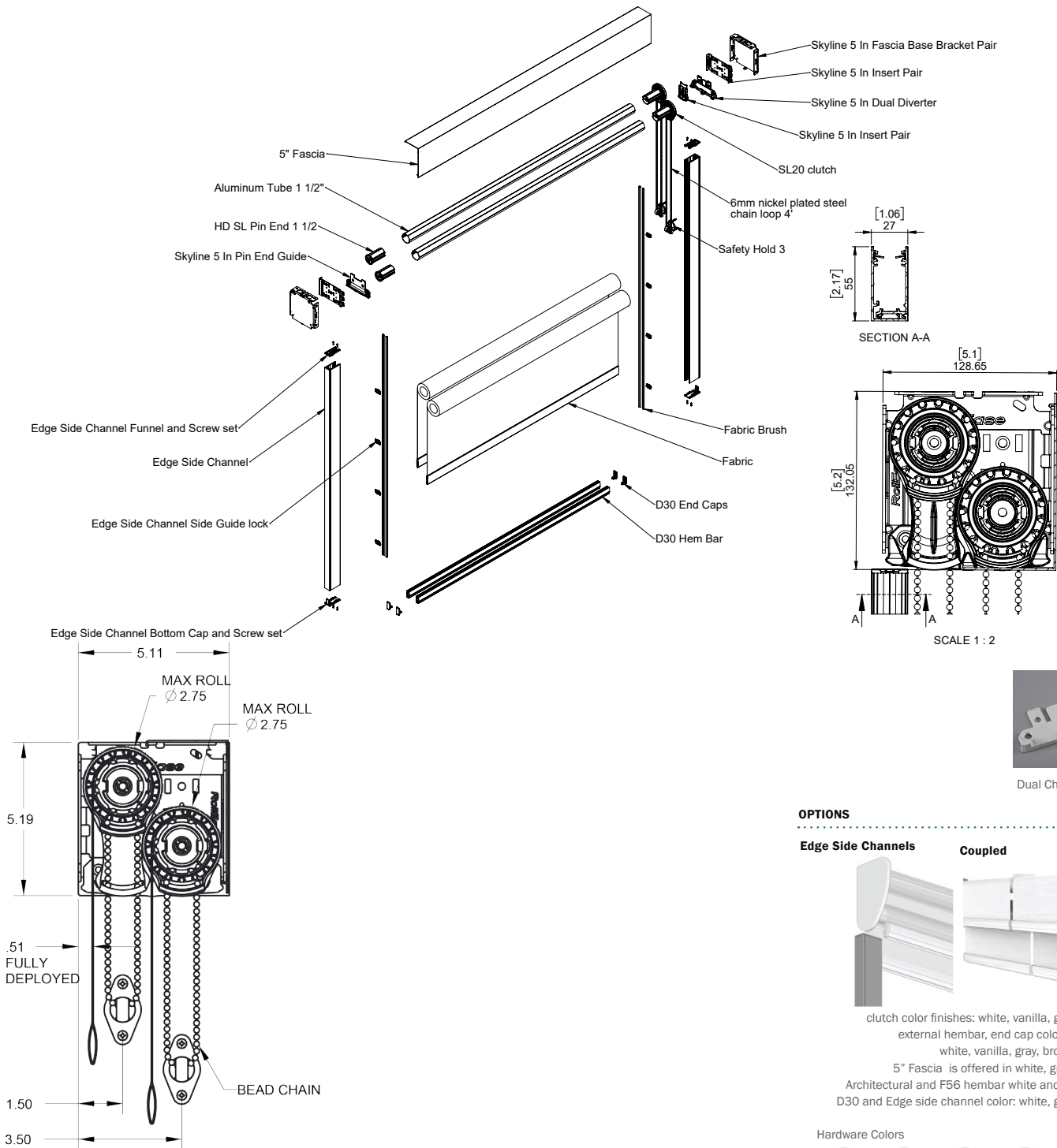

Shade Cloth Deduction Chart

Clutch	Inside Mount	Outside Mount
SL-5, SL-10, SL-15	-1.375"	-1.25"
SL20, Galaxy200	-1.5"	-1.375"

Dual shade brackets are compatible with SL-5, SL-10, SL-15, SL-20 clutches

OPTIONS

Edge Side Channels

Coupled



clutch color finishes: white, vanilla, gray, black
external hembar, end cap color finishes:
white, vanilla, gray, brown, black
5" Fascia is offered in white, gray, brown
Architectural and F56 hembar white and gray only
D30 and Edge side channel color: white, gray, black

Hardware Colors

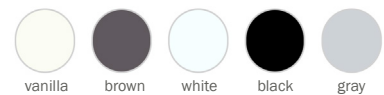

External Hembar Upgrades (Heat Sealed comes standard)



1. Internal 2. Architectural 3. F56 4. D30 5. Exposed (also used for fabric wrapped)



SHADES BY MATISS

Skyline 3", 4", 5", 6" Contract Pocket Roller Shade System (Single)

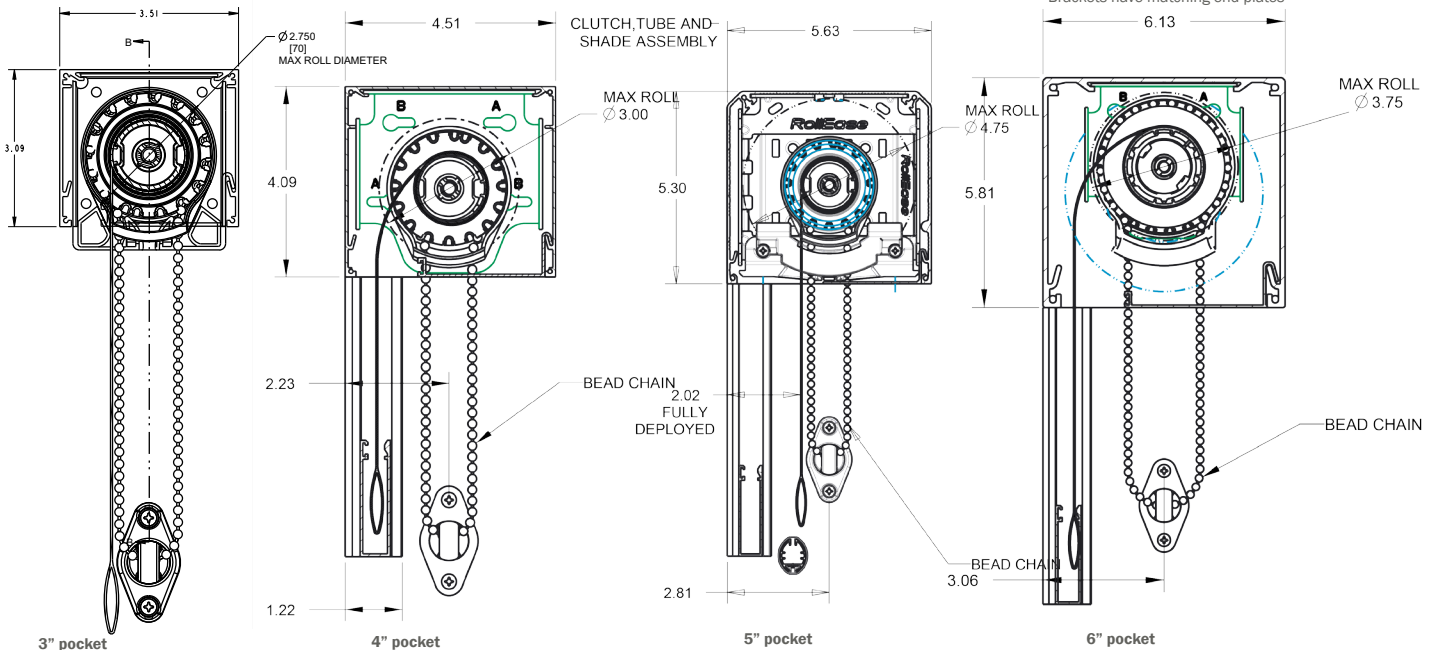
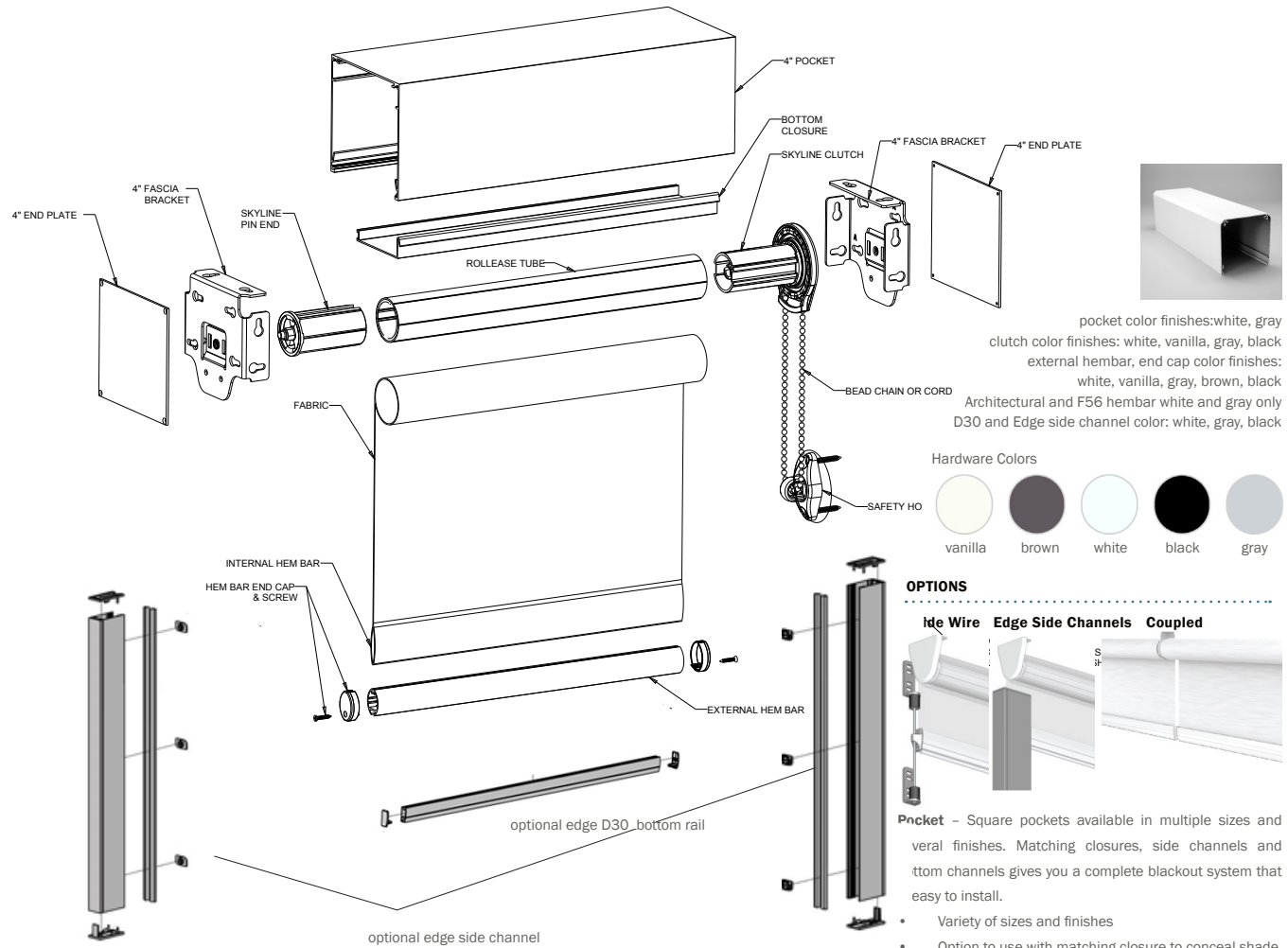

Deductions for shade cloth on pocket systems are the same as for standard clutch roller shades. Note that if end plates are used, an additional -1/4" deduction will be applied to accommodate for end caps. When ordering please specify if end caps should be included. If you add Edge side-channels additional 2 1/2" are deducted from the fabric width.

Skyline 5" Contract Pocket Roller Shade System (Dual)

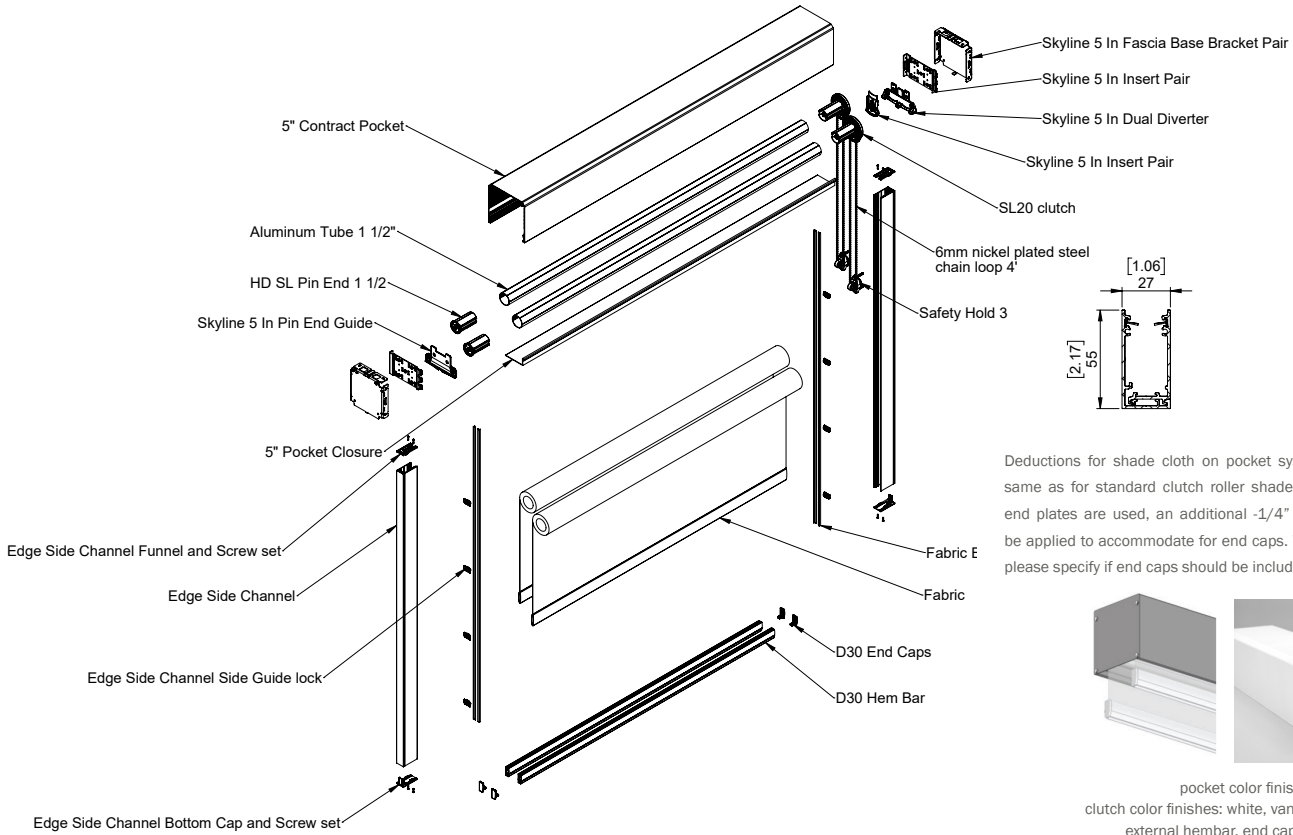

Deductions for shade cloth on pocket systems are the same as for standard clutch roller shades. Note that if end plates are used, an additional $-1/4"$ deduction will be applied to accommodate for end caps. When ordering please specify if end caps should be included.

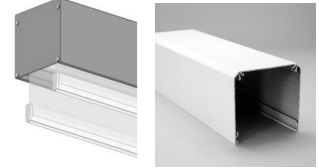

pocket color finishes: white, gray
clutch color finishes: white, vanilla, gray, black
external hembar, end cap color finishes:
white, vanilla, gray, brown, black
Architectural and F56 hembar white and gray only
D30 and Edge side channel color: white, gray, black

Hardware Colors

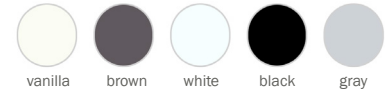

OPTIONS

Edge Side Channel Coupled



External Hembar Upgrades (Heat Sealed comes standard)

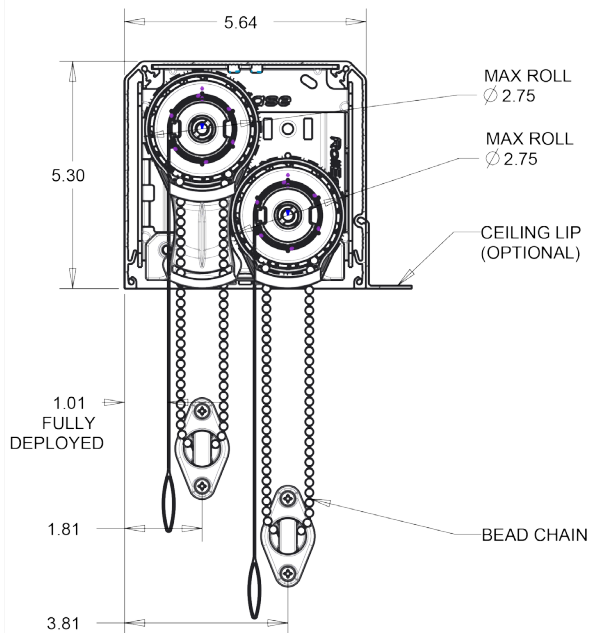

SHADES BY MATISS

Pocket and Closure

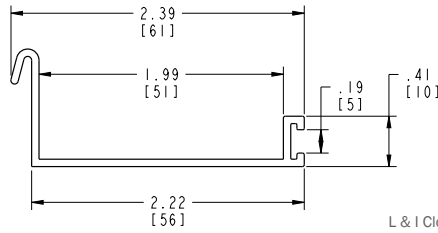
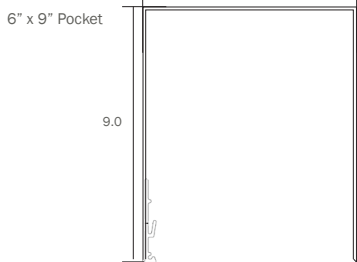
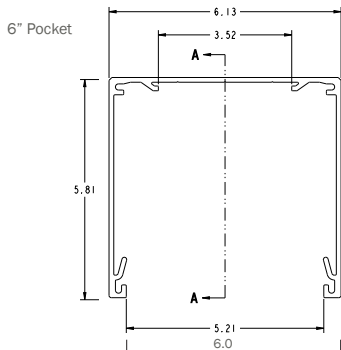
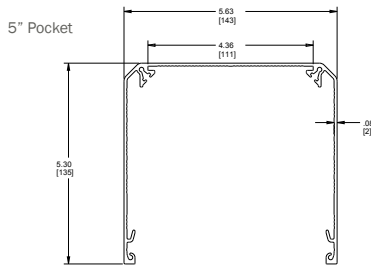
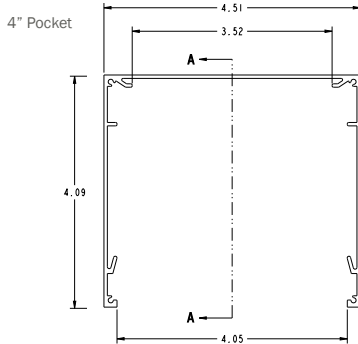
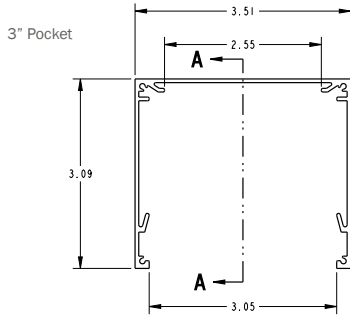

3" Pocket Bottom Closure

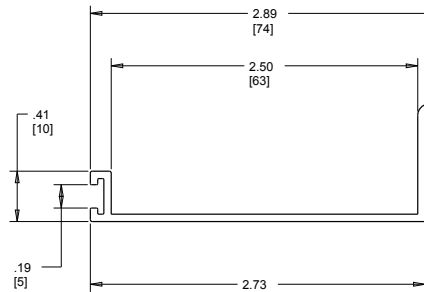

4" Pocket Bottom Closure

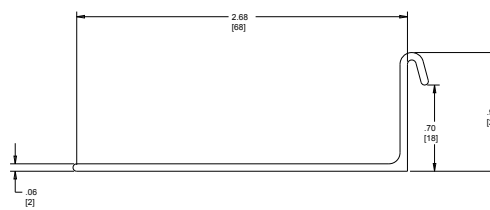

5" Pocket Bottom Closure

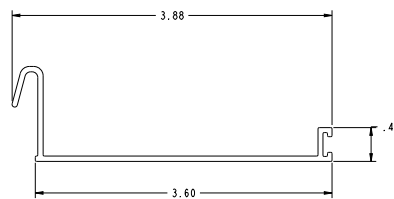

6" Pocket Bottom Closure

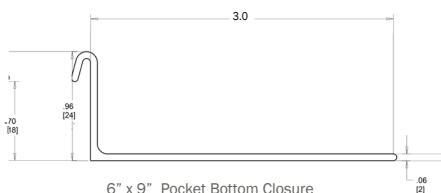

6" x 9" Pocket Bottom Closure

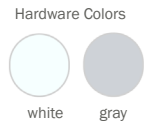

L & I Closure Clips are suitable for installations where roller shade units are recessed inside a pocket and adequate fixtures are available for a Closure Clip to be secured. The Closure Clips offer a simple and cost effective option to the traditional pocket system.

FEATURES AND BENEFITS

- Clip profiles can eliminate the need for a full pocket extrusion in drywall pocket or "no pocket" applications.
- It is a cost saving pocket solution with minimal aluminum achieving a square recess.
- They work with the existing closure panels.
- The L clip features an extended lip that can conceal unsightly cuts.
- The L clips are a smart solution to use with suspended ceilings.
- The I clip is a slimline solution to use with a closure.

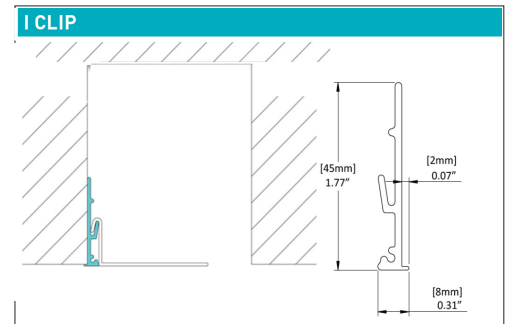
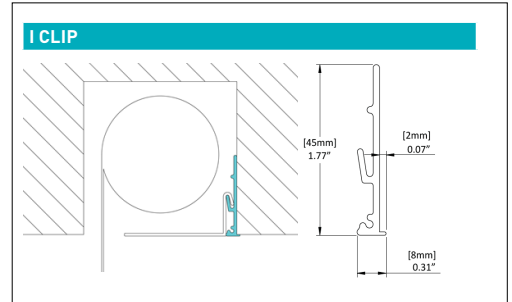
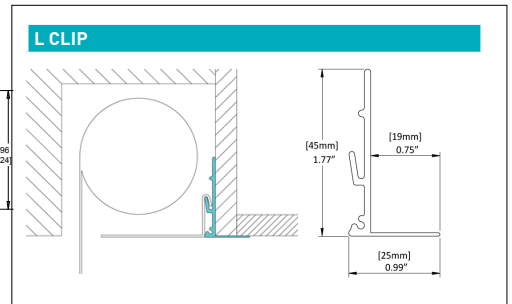

HOW TO PRICE

Add appropriate size side or sill channel surcharge to shade base price. Note! All Base prices are based on ordered dimensions, not finished dimensions of fabric.



SHADES BY MATISS