

## Switch System

The Rollease Acmeda Hook Tube System is an innovative system that lets the user change the fabric of the shade effortlessly even when the tube is installed in cassette. For commercial applications only. Subject to special quoting.

### AESTHETICAL FEATURES

- Fabric can be changed inline with current trends

### PRODUCTION & ASSEMBLY FEATURES

- The tube can remain installed in cassette/fascia when fabric is changed

### FUNCTIONAL BENEFITS

- Easy to remove and reattach fabric to the tube
- Fabric changing functionality to systems fabricated with Rollease Acmeda's most popular clutches, motors and cordless spring system(s) in the US

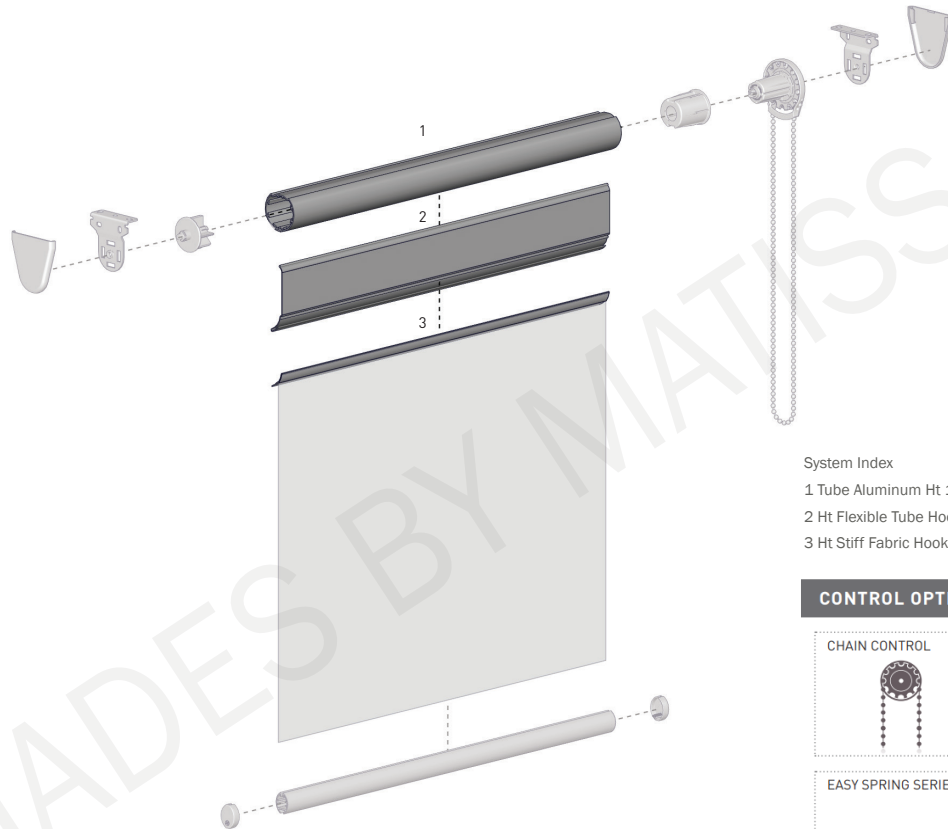

#### System Index

- 1 Tube Aluminum Ht 1-1.5" X 16 Ft Mill Finish
- 2 Ht Flexible Tube Hook Gray- Black- .16Ft
- 3 Ht Stiff Fabric Hook - Black -.16Ft - Taped

### CONTROL OPTIONS

#### CHAIN CONTROL



#### MOTORIZED



#### EASY SPRING SERIES



### SYSTEM AVAILABILITY

- SKYLINE
- R-SERIES
- EASY SPRING PLUS
- EASY SPRING ULTRA
- EASY SPRING WAND
- AUTOMATE

### ASSEMBLY INSTRUCTIONS

- ① ATTACH SPLINE TO THE TUBE

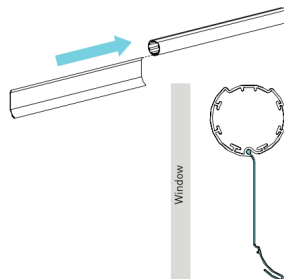

- ② ATTACH THE STIFF HOOK AS SHOWN TO THE FACE OF THE FABRIC

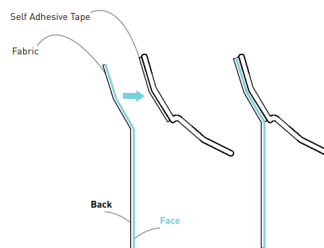

- ③ ATTACH FABRIC HOOK TO THE FLEXIBLE TUBE HOOK

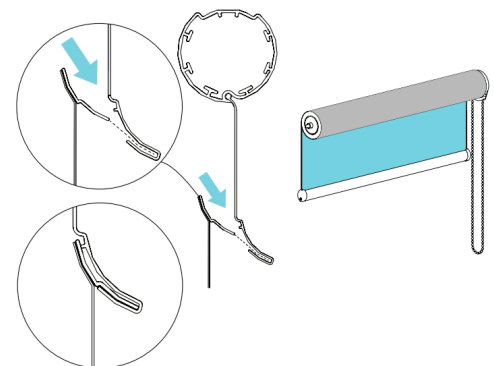

### CHANGING THE FABRIC

Remove the Fabric from the Fabric Hook and repeat step 2 and 3.

