



### Classic Flat Style

This traditional roman shades folds neatly when raised and lies flat when lowered. These shades work well with any fabrics and are highly recommended for patterned fabrics.



### Knife/Back Pleat Style

Doweled pockets on the back of the shade form decorative seams on the front of the shade. These shades work best with solid fabrics and patterned fabrics.



### Ribbed/Front Pleat Style

This style is a reversed Knife pleat with the pockets to the front of the shade, accenting each pleat. These shades work best with solid or textured fabrics.



Roman Shade Specification	
Liner Options (White Color Only Supplied by SBM)	Unlined, Privacy, Blackout
Pleat Style	Ribbed/Front Pleat Knife/Back Pleat Classic/Flat
Side Hems	1.5" Blind Stitched
Bottom Hem Options	1.5" Blinds Stitched (Sheer or Lined)
Minimum Width*	24"
Maximum Width*	156"
Minimum Height*	36"
Maximum height*	156"
Seam Exposure	Ripplefold draperies made in multiple widths may have visible seams. Workroom may railroad fabric to avoid seams where possible.
Pleat Distance	6" Standard
Alignment	Top, Bottom. Standard
Operation	Metal Chain Standard The shade waterfalls off the front of the headrail, the controls are hidden behind the shade or Motorized
Motorization Option	Rollease Acmeda



Back Safety Tape

Our roman shades feature a slim profile without a valance top, and attach to the rail with a velcro. The Back of the shade has a safety compliant tape.

Chain Control shades are supplied with a chain hold tension device.

All Classic, Knife Pleat and Ribbed Pleat Roman shades are constructed with support rods that are hidden between the face fabric and the lining at no additional charge. Support rods provide stability and crisp, neat folds.

All Soft Roman Shades are finished at the bottom with a neatly sealed bottom hem. 1.5" tunnel with internal metal hembar.

Measuring Notice: Workroom will deduct 1/8" for inside mount

Due to fabric content, some fabrics are not suitable for fusing. One yard of fabric may be requested for testing. For the best results please choose dimensionally stable drapery fabrics.

Plaids, Silks, 100% synthetic, tapestry, very heavy fabrics, loose weave linens, sheers and fabrics with raised patterns are not suitable for fusion. Because of the nature of fabric, striped patterns may not be perfectly straight. Rare or irreplaceable fabrics should not be sent in for fusing. All fabrics are subject to approval.

### C.O.M Yardage

To determine the amount of yardage required for a C.O.M. shade call customer service with your shade style.



Top Alignment

Bottom Alignment

Motorization / Rollease Acmeda CL 0.6 Cordlift motor  
Cord lift technology. Low voltage. 3 speed settings.

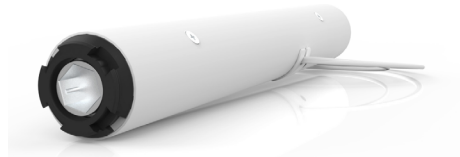

### PRODUCT SPECIFICATIONS

Part #: MTDCRF-CL-0.6-50 Cord Lift 0.6 Nm Motor

Voltage	12V DC	Limit Switch Type	Electronic
Torque	0.6 Nm	Current	1.0 A
Max Run Time	12 min	Battery Size/Type	External Battery Pack
Speed	50 RPM (Adjustable to 42 or 34)	Temp Working Range	32°F to 140°F (0°C to 60°C)
Radio Frequency	433.92 MHz	Insulation Class	1 CL B
RF Modulation	FSK	Sound Level	48dB
IP Rating	IP20	Power	12W

### DIMENSIONS

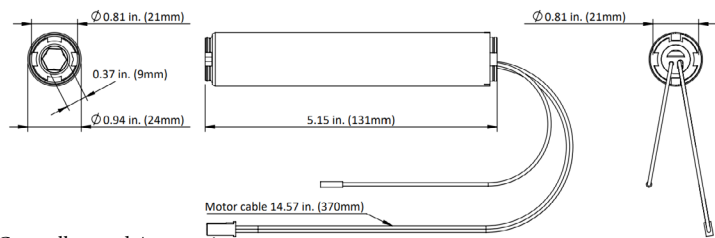

### Controllers and Accessories



Pulse 2 Hub / App



Push 1, 5, 15 Channel



Power Supply



Battery Pack



A Division of Rollease Acmeda

Knife Pleat and Ribbed Pleat shades may have noticeably different top or bottom fold sizes when multiple shades with different lengths are in the same room.

The standard construction aligns the pattern and folds starting at the BOTTOM of the shade. Matching starting from the TOP is a no charge option but must be requested.

Top alignment is recommended for side by side window openings of different heights

Roamn Shade Headrail Profile  
Contemporary slimline aluminium profile  
End covers for a neat overall finish

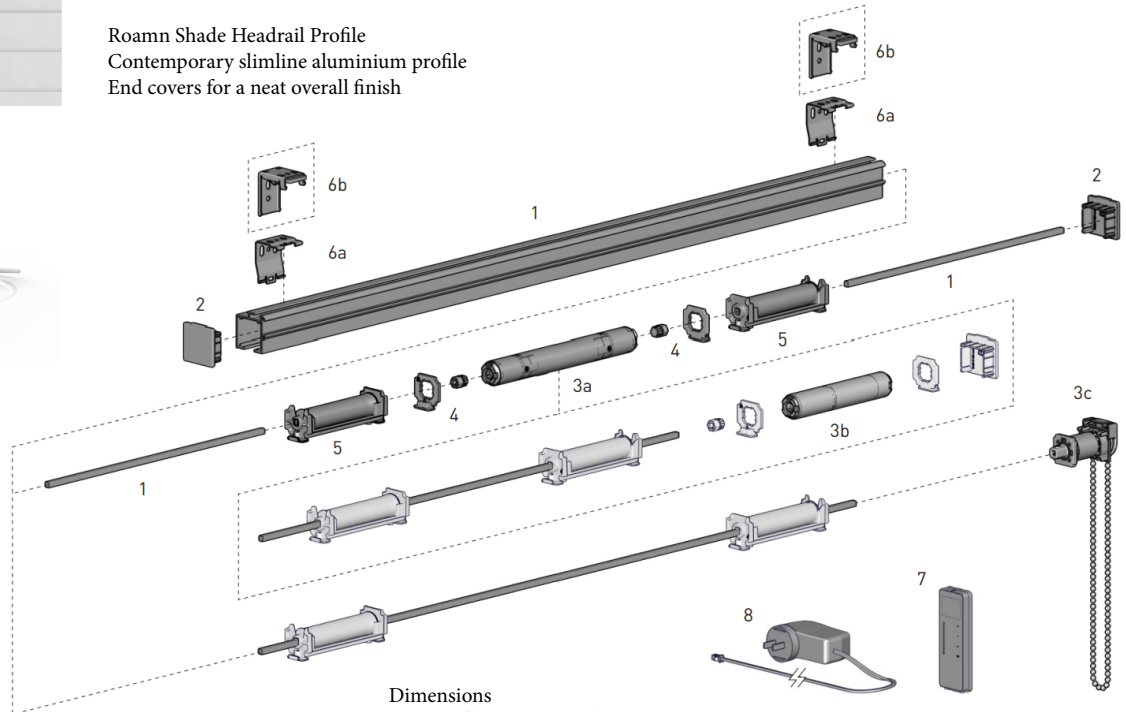

### Dimensions Low Profile Mounting Clip

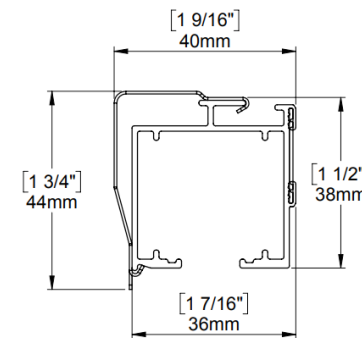

- 1 SS38 Head Rail [incl. crimp tape + rod]
- 2 SS38 Head Rail End Cap
- 3a Cord Lift Motor
- 3b Cord Lift Motor
- 3c SS38 Drive Unit
- 4 Cord Lift Motor Adapter Kit
- 5 SS38 Spool cone
- 6a SS38 Mounting Clip/Bracket
- 7 Remotes & Switches
- 8 Power Solutions & Extension Cables



Account #	Account Name
Address	
City/State/ZIP	
Phone	Fax
Ordered By	
Date Ordered	Required Date
Sidemark	Customer P.O.#

Ship To	Attention
Address	
City/State/ZIP	
Phone	Fax
Ship Via	Delivery
	Pick Up
	Carrier

Line No.	Room Tag	QTY	Width Measure to 1/8"	Length Measure to 1/8"	Fabric Supplier	Fabric Name	Fabric Color	Style	Control	Mount	Lining	Alignment	Side by Side with line
1								Knife/ Back Pleat Ribbed Front Pleat Flat/Classic	Chain Right Chain Left Motorized	IB OB	Unlined Premium Blackout	Top Bottom Standrad	
Notes:													
2								Knife/ Back Pleat Ribbed Front Pleat Flat/Classic	Chain Right Chain Left Motorized	IB OB	Unlined Premium Blackout	Top Bottom Standrad	
Notes:													
3								Knife/ Back Pleat Ribbed Front Pleat Flat/Classic	Chain Right Chain Left Motorized	IB OB	Unlined Premium Blackout	Top Bottom Standrad	
Notes:													
4								Knife/ Back Pleat Ribbed Front Pleat Flat/Classic	Chain Right Chain Left Motorized	IB OB	Unlined Premium Blackout	Top Bottom Standrad	
Notes:													
5								Knife/ Back Pleat Ribbed Front Pleat Flat/Classic	Chain Right Chain Left Motorized	IB OB	Unlined Premium Blackout	Top Bottom Standrad	
Notes:													

This order is custom made and cannot be changed or cancel once goods are cut.